

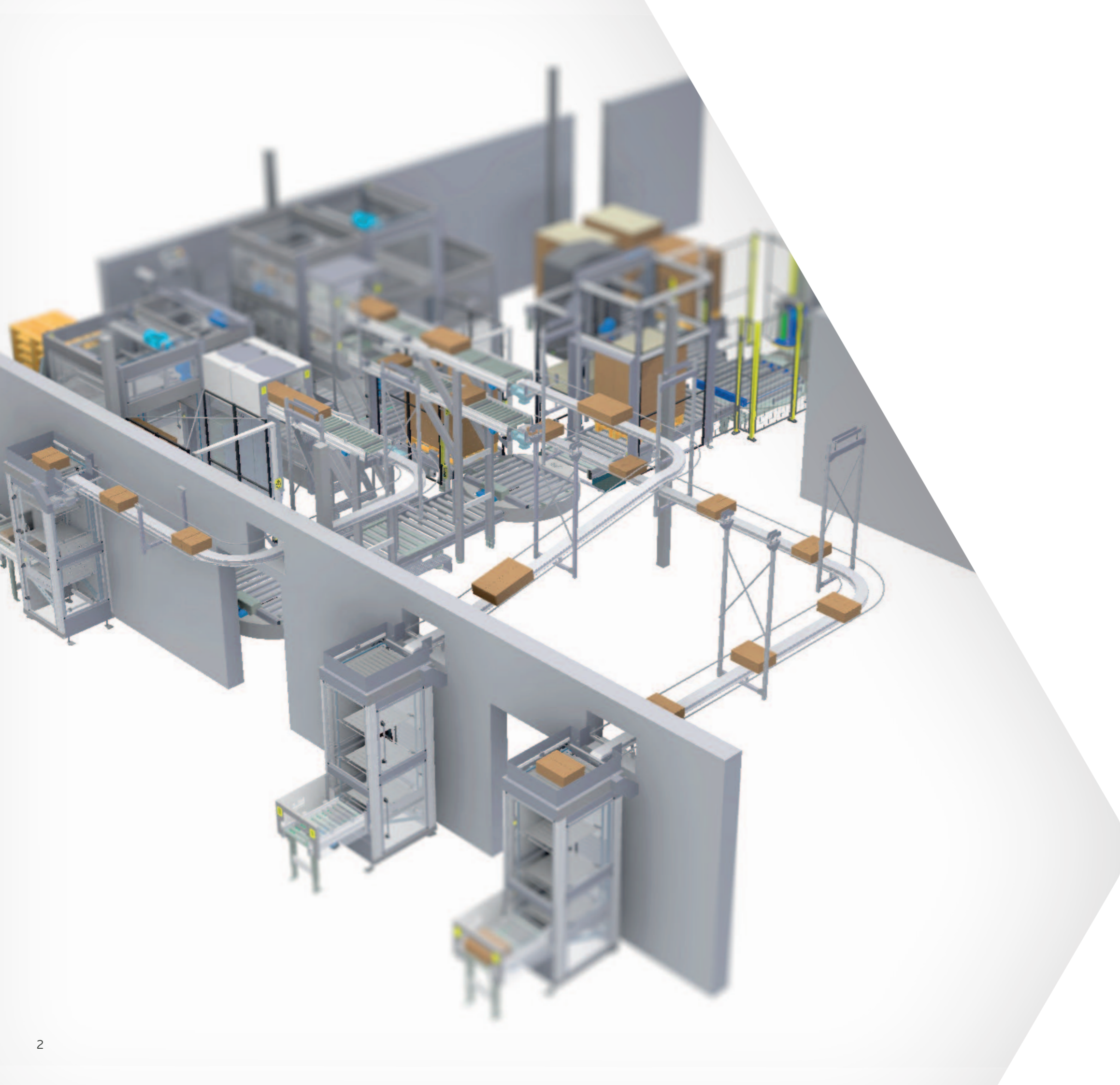

# PackTech

Total supplier  
of packaging  
automatization





# PackTech

**PackTech delivers complete solutions for efficient packaging lines. With more than 35 years of experience and over 900 installations and upgrades for customers throughout the Nordic area, we are experts in reliable and efficient solutions.**

As part of VPK Nordic, with factories in Norway, Sweden and Denmark – we offer products throughout the value chain – from design and production of packaging, to complete packaging lines fully customized.

VPK Packaging own 50% of Österbergs Förpackningsmaskiner AB in Sweden, and we have a partnership with Intersystem AB and Carryline AS – which together account for most of our machine supplies. Our close relationship with our machine manufacturers enables us to deliver efficient, competitive and value-creating solutions.

# Service

**Our engineers and technicians have extensive experience in developing functional and value-creating packaging and machine solutions in a demanding and quality-conscious market where the focus is profitability, efficiency and user friendliness.**

We take full responsibility for layout, engineering, installation and start-up, and we will at the same time ensure that everyone involved receives good training, fast service and assistance regarding improvements throughout the life cycle. We offer customized service agreements that ensure response time in line with the customer's requirements.

## Services

- Layout
- Engineering
- Installation
- Start-up
- Training
- Service and upgrades
- Spare parts



# WrapAround Österbergs W50

Österbergs W50 is a dynamic, agile and user-friendly machine.

The machine has servo drives for smooth and controlled movements, thus keeping mechanical loads to a minimum and increasing the lifecycle – so that you save costs related to service and maintenance. The W50 is a standardized basic machine that shapes and glues a sheet of corrugated board around the product that comes from the integrated grouping system. We have a wide range of modular grouping systems.

- **Space efficient**
- **Well-proven**
- **User-friendly**
- **Short set-up time**
- **Open and stable construction**
- **Stainless steel**
- **Food adapted**



## Paper magazine

The paper magazine is located at an ergonomic height. It is user friendly and has a large loading capacity.

## Sheet feeding

The infeeding is automatically adjusted. The chains are maintenance-free.

## Set-up

The machine is designed to minimize number of adjustments. It has a simple and precise adjustment with digital displays, or fully automatic adjustment as an option. Ergonomic design.

## Folding station

Flexible, open and stable construction.

## Feeding

Flexible infeed with a feeder carriage centered above the product. Stable and light construction with servo-drive.

## Design

The frame is made of welded stainless steel for extra stability. Cables are placed above and inside the frame. Its open design provides good accessibility for operators and maintenance.

## Specifications Österbergs W50

Sheet dimensions	Min	Max
L	100	470
W (WA)	75	400
H (WA)	35/70	300
I	-	750
D	35	155
E	35	50

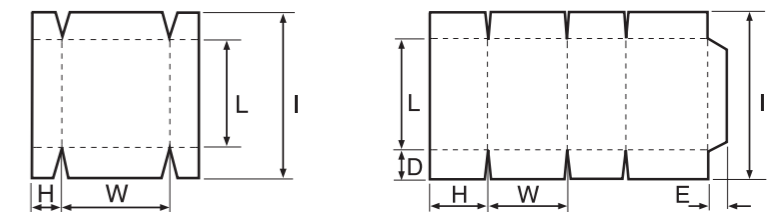
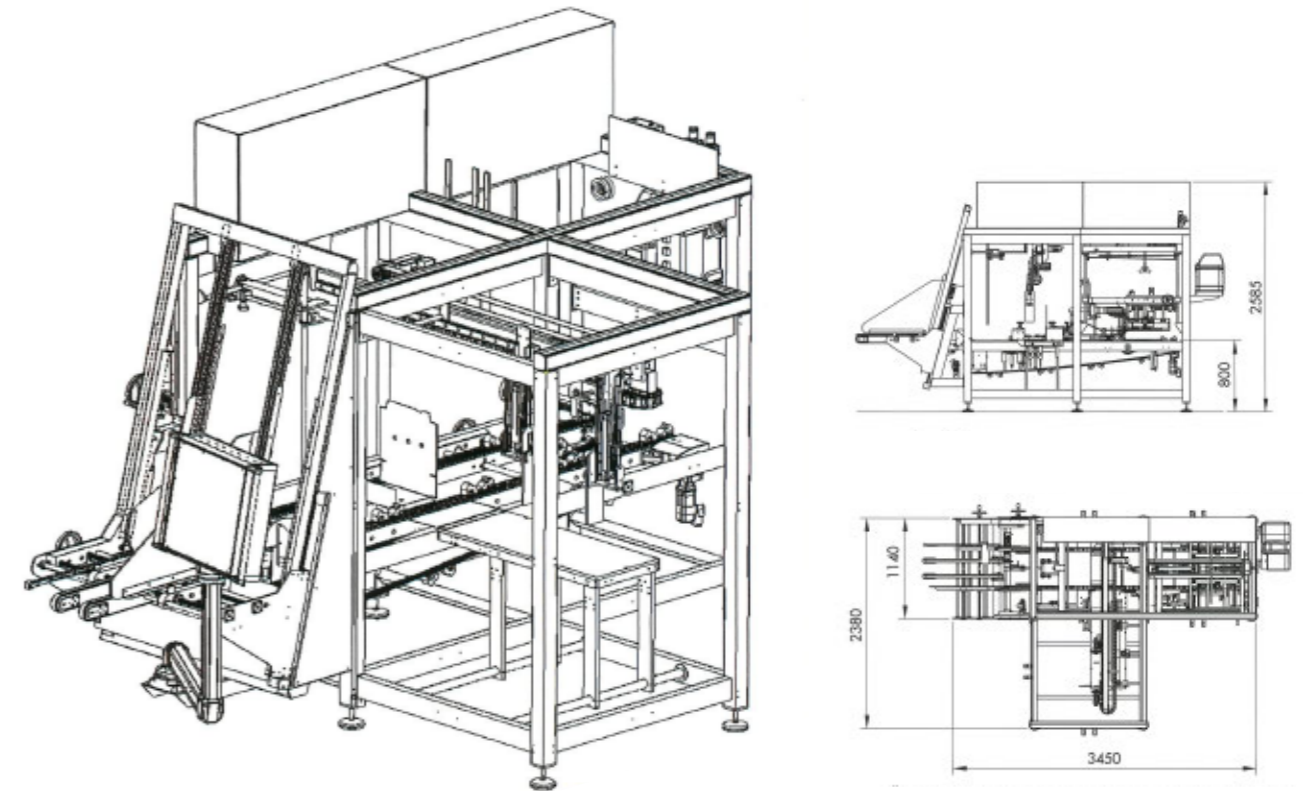

# WrapAround

Some of our most commonly used WA-solutions are:

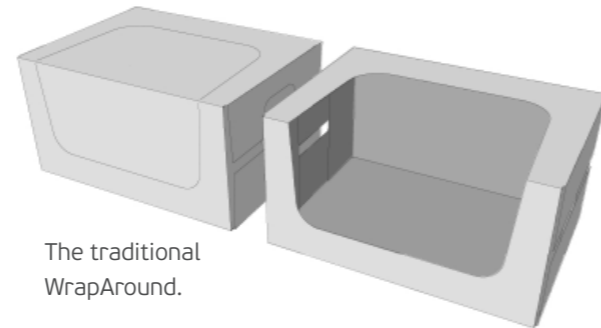

The traditional WrapAround.

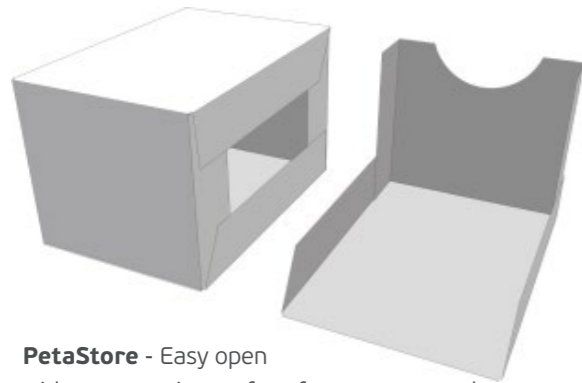

**PetaStore** - Easy open with an extensive surface for exposure and none visible tear edges. Perfect for efficient product replenishment and very suitable for stacked products.

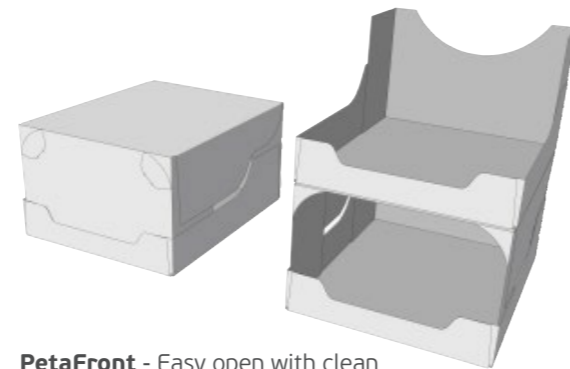

**PetaFront** - Easy open with clean edges. Easily handled with one-handed grip without knife and placed in the shelf on three seconds. Suitable for standing products.

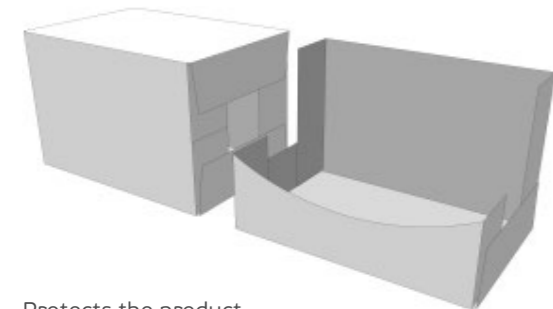

Protects the product. To be customized with various opening functions. Suitable for self-supporting products

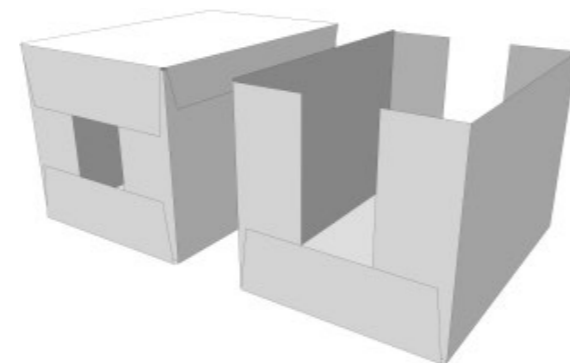

Top open. Suitable for frozen products. Well suited as transport packaging.

# PetaFront

Increase your competitiveness through the latest generation of shelf ready packaging.

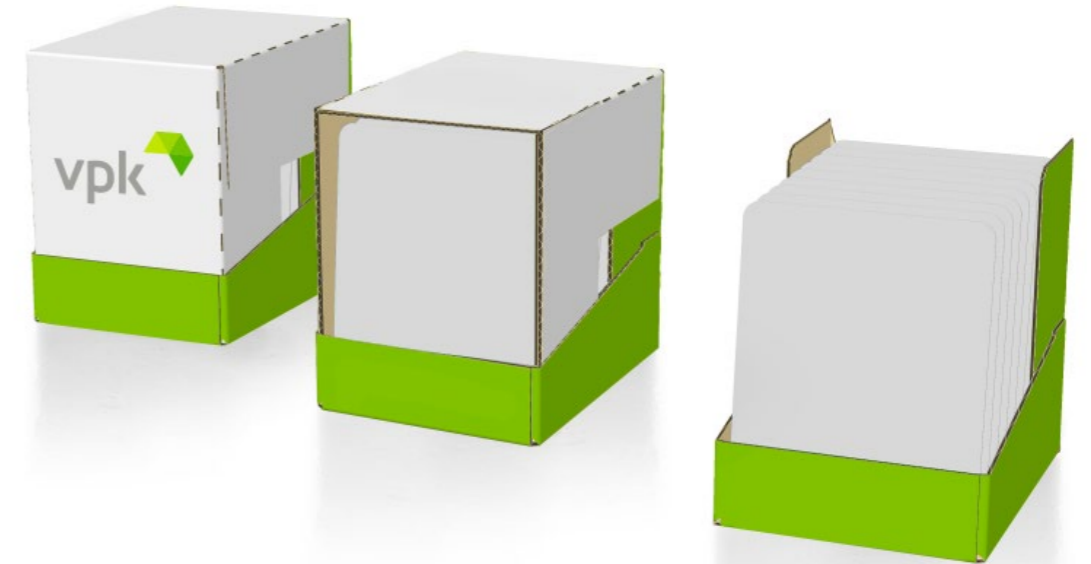

**The packaging's main purpose is to protect the product, simplify the logistics, ensure fast product replenishment and, most important; sell your product.**

PetaFront is a single wrap around that simplifies logistics and the packaging process, while having all the advantages of any traditional tray. The packaging is easily formed around the primary product in a standard packaging machine, adapted to automatic warehouse management.

PetaFront is designed to provide a much more time-efficient product replenishment in store. The packaging solution is easily handled with a one-handed grip without the need for a knife, and is placed on the shelf within 3 seconds!

Are you tired of unsightly tearing edges that take your attention away from the product? Then PetaFront is the solution for you.

During development, we have emphasized soft lines and a clean front. In the battle for attention in stores, PetaFront makes your product stand out from the mass! If you want to give your product a competitive advantage, choose PetaFront.

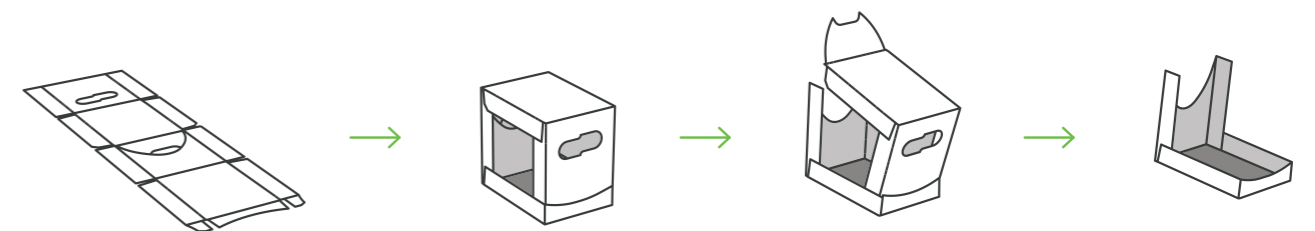



Optional digital display for efficient adjustment of the machine



Stainless and maintenance-free chains

# Tray Österbergs S40/S60

Österbergs S40/S60 is one of the most solid and well-proven machines on the market for erecting and gluing trays.

The machine has a capacity of 25 trays per minute. Easy format change. The top model S60 is especially suitable for trays with reinforced triangle corners, or for customized packaging solutions.

- Pallet infeed
- Space efficient
- Well-proven
- Stainless steel
- Efficient
- Agriculture
- Food Industry



## Specifications Österbergs S40

Sheet dimension	Min	Max
I	640	1 120
S	-	780
L	310	600
W	170	400
D	35	155
H	35	200
Capacity	Up to 25 trays per minute	
Energy	6,5 kW	
Air-consumption liters / cycle at 6 bar	30 NI / cycle	
Weight	700 kg	

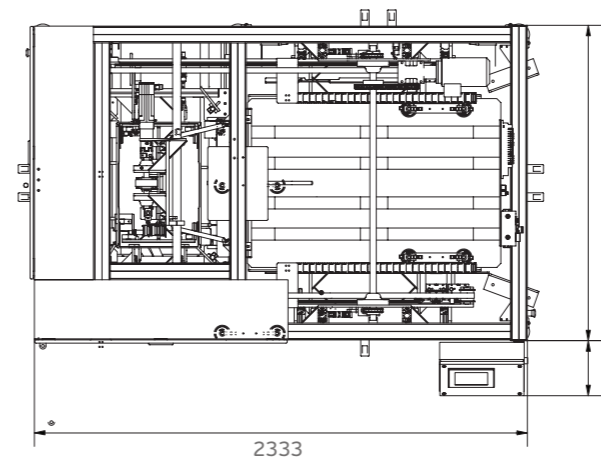
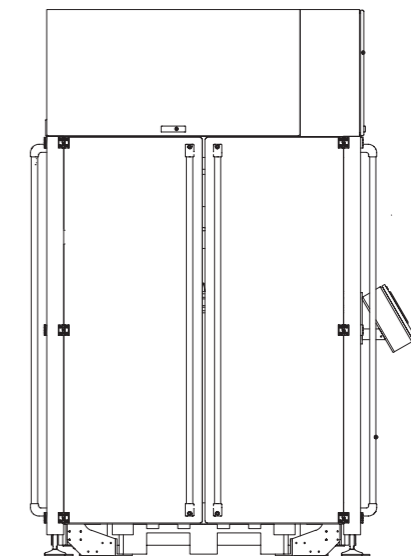
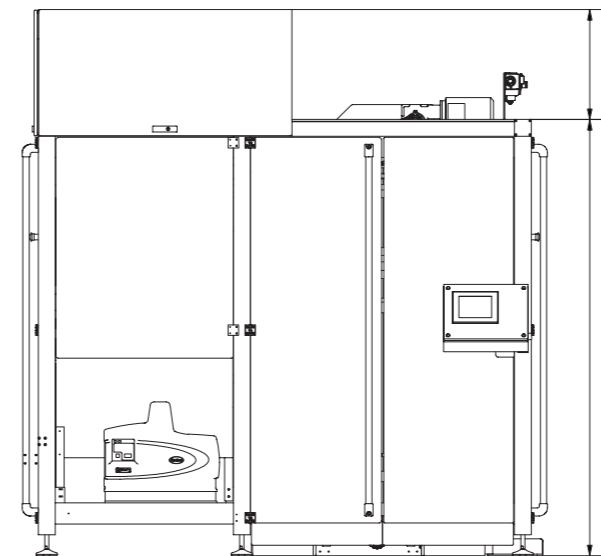
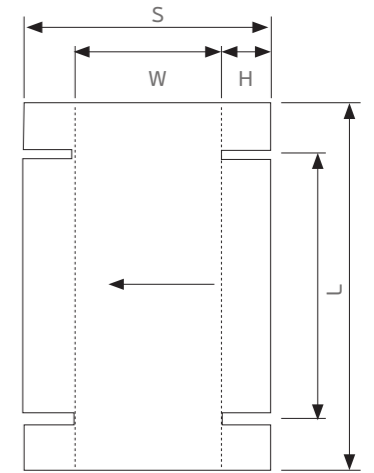

Tray - Österbergs S40

# Trays

Some of our most commonly used tray solutions:

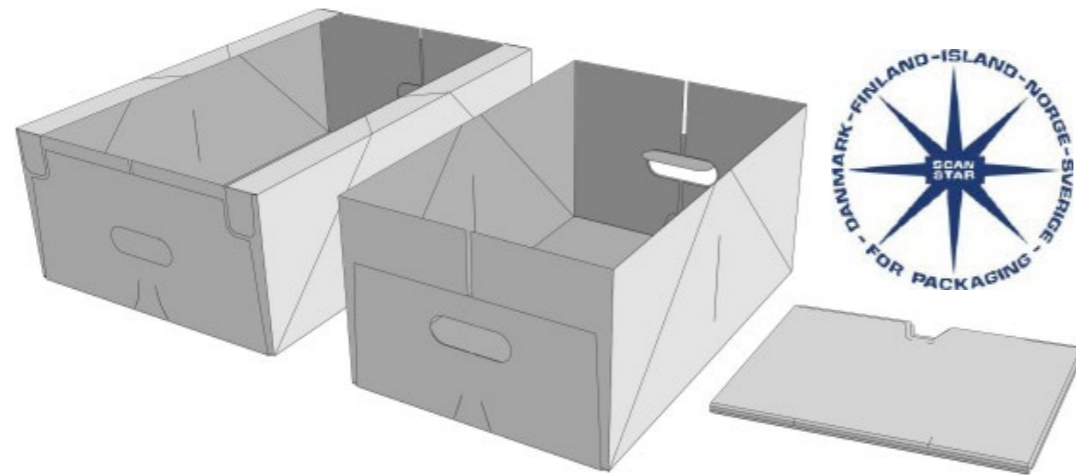

**PetaFold** – The perfect solution for home deliveries. Easy to fold for recycling. With strengthened sides on top – for stability during transportation. A future-oriented and sustainable solution.

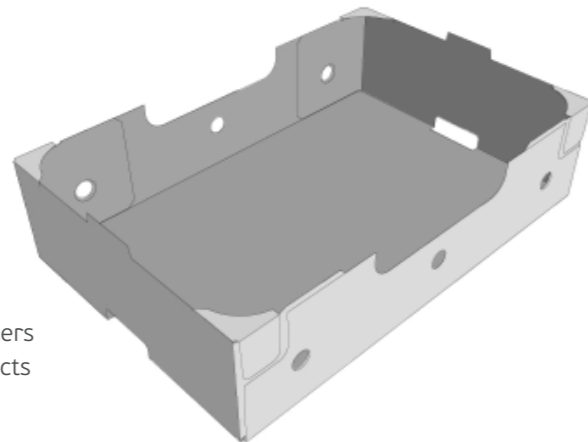

Tray with stacking corners for easy filling of products

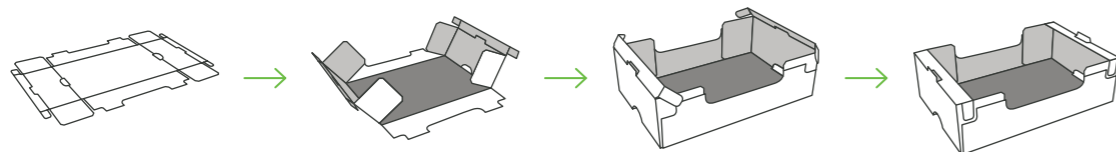



# Tray/Lid Österbergs S4 Fish

Österbergs S4 is one of the most solid and well-proven machines on the market for erecting and gluing trays. The machine has a capacity of 25 trays per minute.

- Pallet infeed
- Space efficient
- Well-proven
- Efficient
- Stainless
- Pelagic industry



## Specifications Österbergs S4 Fish

Sheet dimension	Min	Max
I	798	810
S	600	612
L	577	604
W	382	408
H	102	114
Capacity	Up to 25 trays per minute	
Energy	6,5 kW	
Air-consumption liters / cycle at 6 bar	30 NL / cycle	
Weight	700 kg	

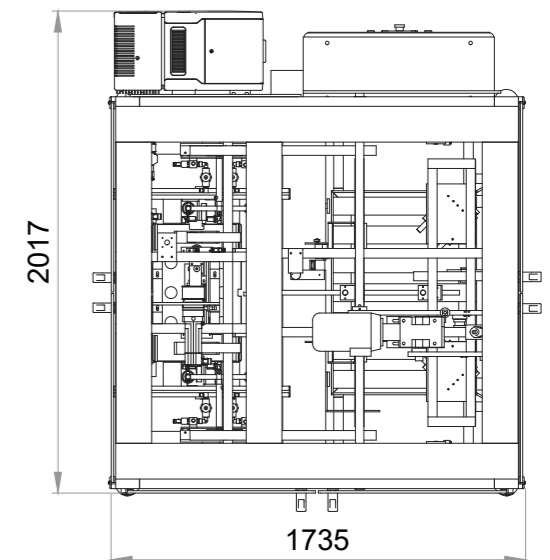
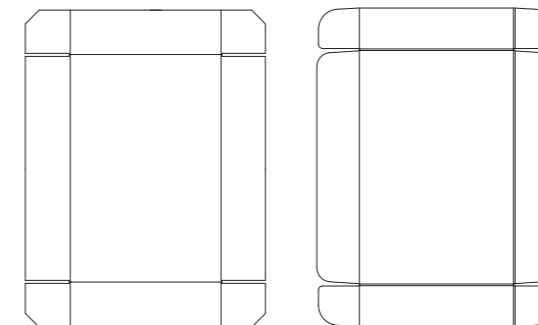
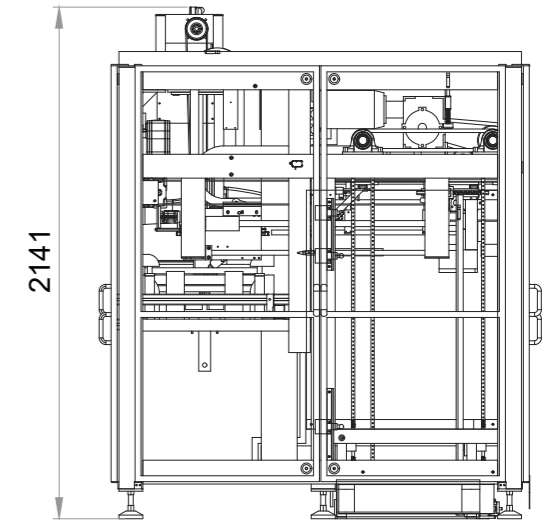
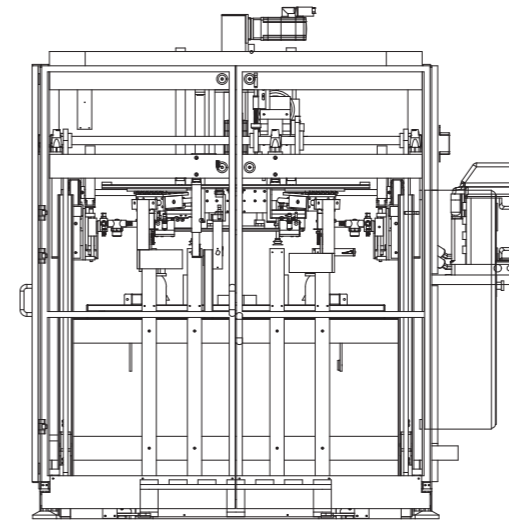
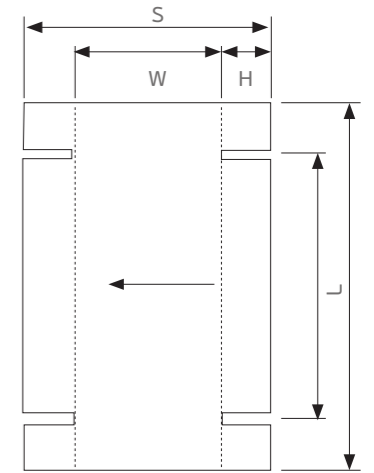

Tray/Lid - Österbergs S4 Fish



# American folding boxes

## Case erectors

PackTech offers automatic machines for erecting and sealing of all types of American folding boxes. Quick and easy format change according to the customer's requirements. Designed in stainless steel with compact dimensions, with very few moving parts, you get an operator-friendly machine with a minimum of necessary maintenance.

- **Stainless**
- **Easy change of format**
- **User friendly**
- **Low maintenance**



# American folding boxes

Some of our most commonly used American folding box solutions:

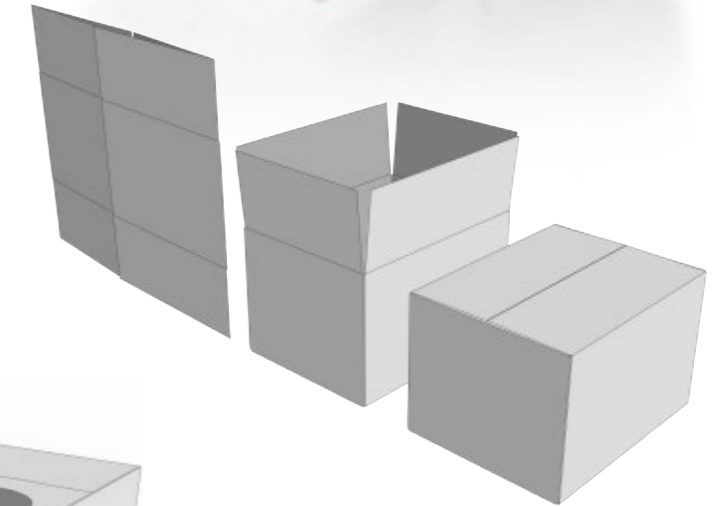

The standard American folding box

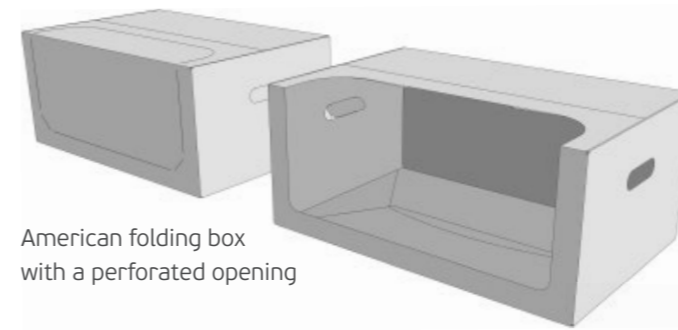

American folding box with a perforated opening

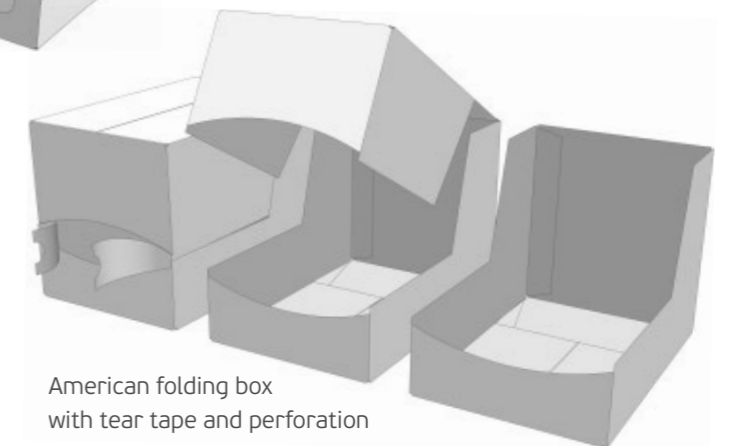

American folding box with tear tape and perforation



# Top and bottom sealer

Our range of sealing machines covers everything from the simplest requirements, from semi-automatic top and bottom sealers, to those that automatically adjust to the box sizes.

- In stock
- W: 110mm-500mm / H: 120mm-500mm
- Easy to change to different box sizes
- Flexible roller conveyors for output and buffering
- Adjustable length from 1.5 to 4.5 metres

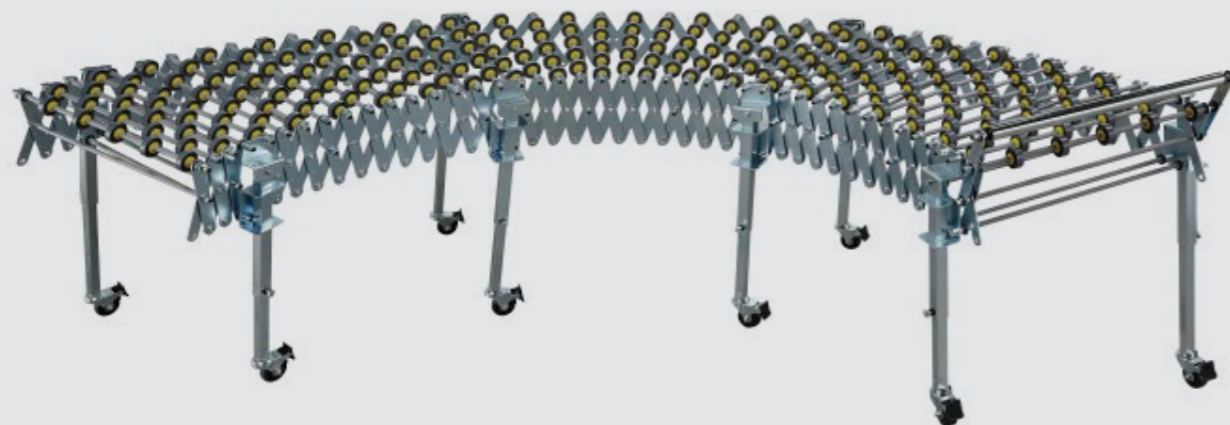

Semi automatic taping machine and flexible roller conveyor



# Palletizing with a palletizer Intersystem ComPact

Intersystem ComPact meets the requirements for operational reliability, flexibility and user-friendliness. The machine is space-efficient and can be adapted for both automatic and manual handling. The flexible construction makes it easy to change between different pallet patterns. It can operate from several production lines simultaneously.

- **Space efficient**
- **Stable handling of products**
- **Easy change to different pallet patterns**
- **High speed**
- **Low operating and maintenance costs**

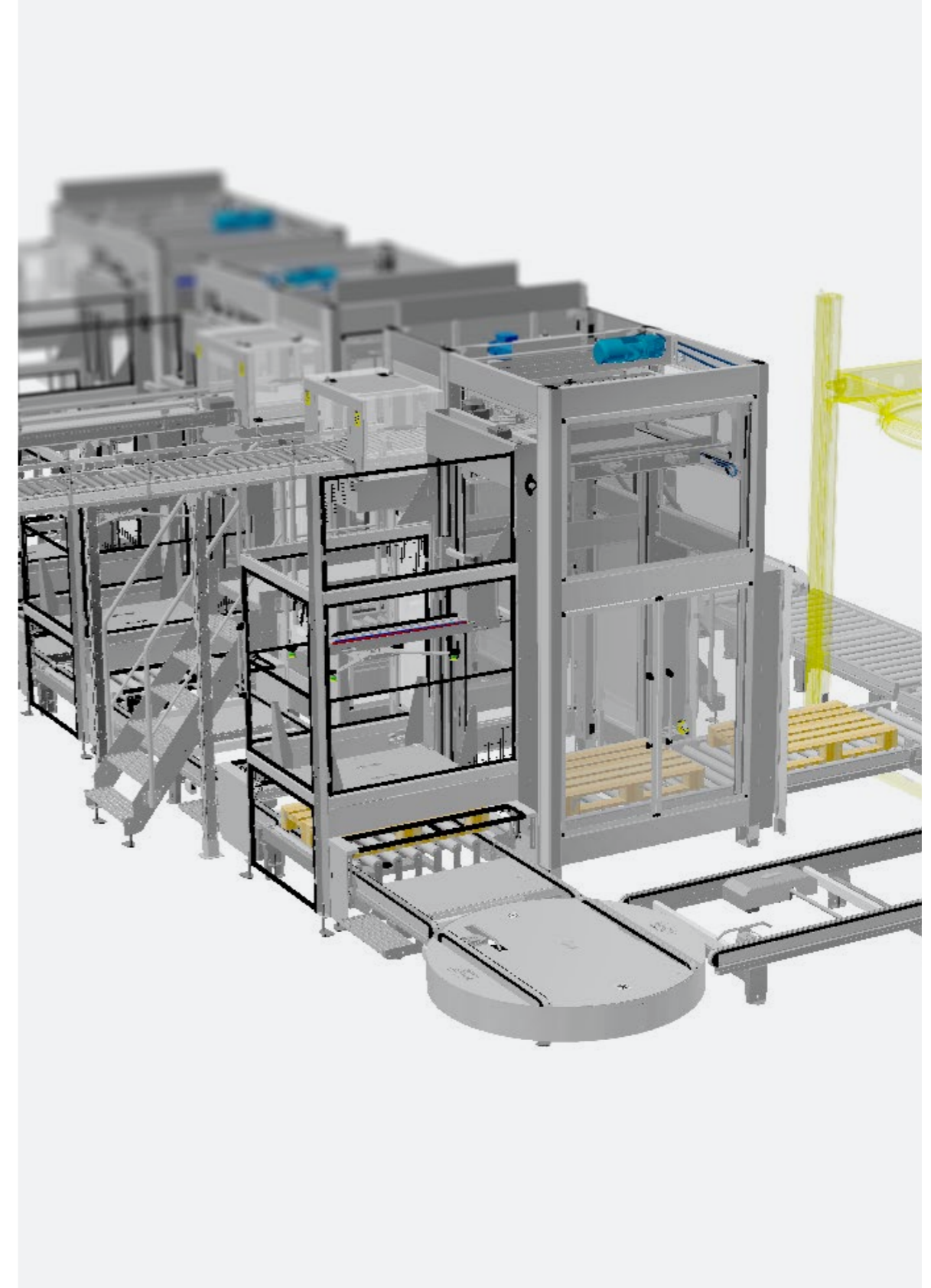

# Palletizing with robot Österbergs PaC

Robots are particularly suitable where it's flexibility can be utilized for several tasks. For example, when products and tasks require it to pick up and deliver in different locations and in different patterns. Our application supplier specialized for robots is Österbergs, who delivers Kuka-robots in combination with conveyor systems.

- **Great production flexibility**
- **Space efficient**
- **Low operating and maintenance costs**
- **Multifunctional tool**
- **Serves multiple production lines simultaneously**



# Conveyors and transport systems

PackTech designs systems for moving products, boxes and pallets. Together with the customer, we agree upon a solution. To ensure an optimal flow of goods, the solution is adapted to, and integrated with the customer's production line.

- **Modular and adaptable**
- **Low operating and maintenance costs**
- **Several options available**
- **Can be delivered in aluminum and stainless steel**

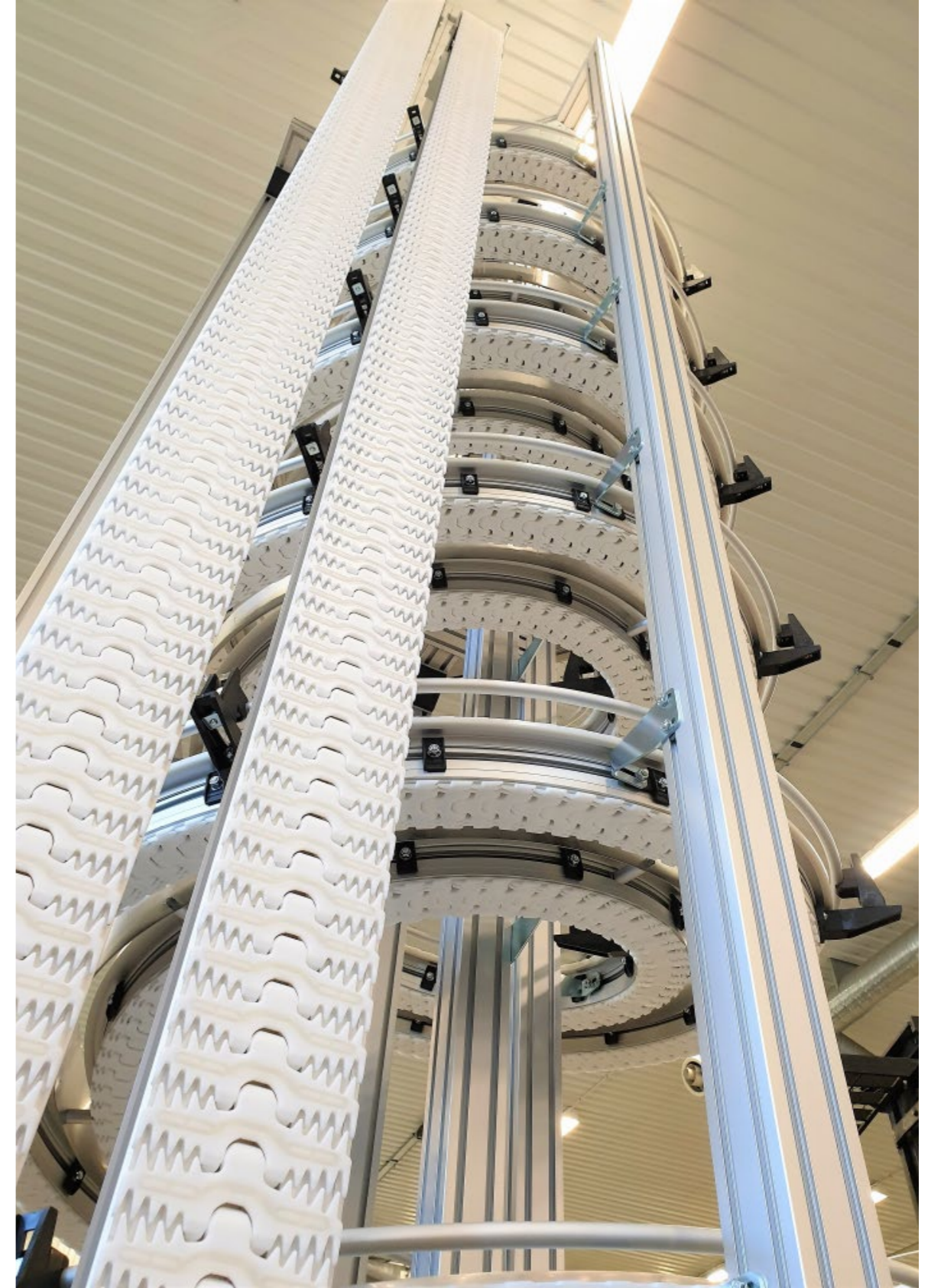
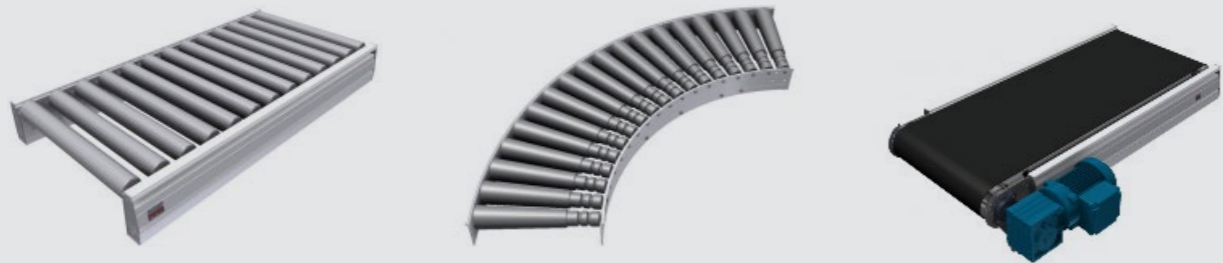

# Pallet wrapper machines

We offer a selection of semi- and fully automatic pallet wrappers that cover most requirements. The machines can be delivered with different types of pre-stretch, which gives lower consumption of stretch film, as well as a more stable pallet. The pallet wrapper is integrated in the production line with approved safety.

- **Multiple program choices**
- **Horse shoe for jack trolley**
- **Soft start and stop**
- **Adaptable**
- **Low operating and service costs**





# Contact us

## PackTech Customer service:

+47 90 53 04 44  
packtech@vpkgroup.com

VPK Packaging AS  
PackTech  
Jellestadveien 37  
1739 Borgenhaugen  
Norway



**Tommy Proitz**  
General Manager PackTech  
+47 95 899 047  
tommy.proitz@vpkgroup.com



**Kai-Petter Olsen**  
Project Engineer  
+47 90 84 12 64  
kai-petter.olsen@vpkgroup.com



**Lars Hansen**  
Project Engineer  
+47 99 22 77 13  
lars.hansen@vpkgroup.com



**Henrik Finnestad**  
Technical Manager  
+47 91 70 76 09  
henrik.finnestad@vpkgroup.com





[www.vpkgroup.com](http://www.vpkgroup.com)